

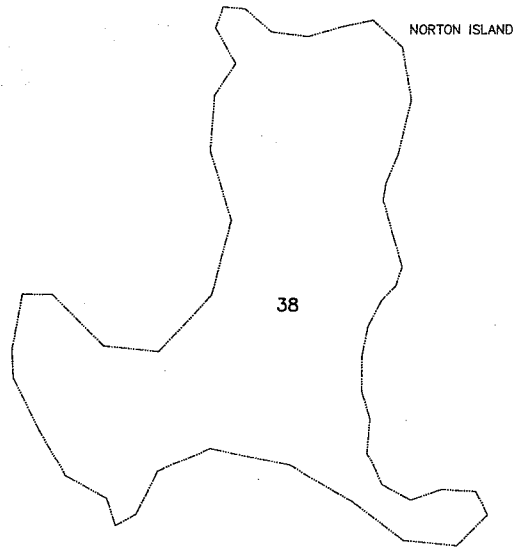

PLEASANT BAY

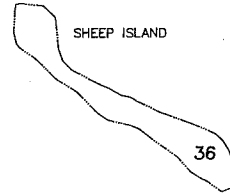

M 19

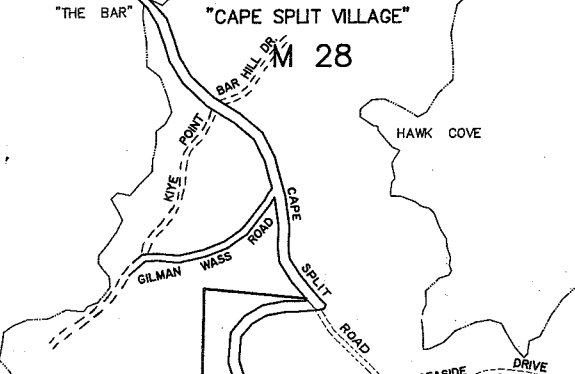
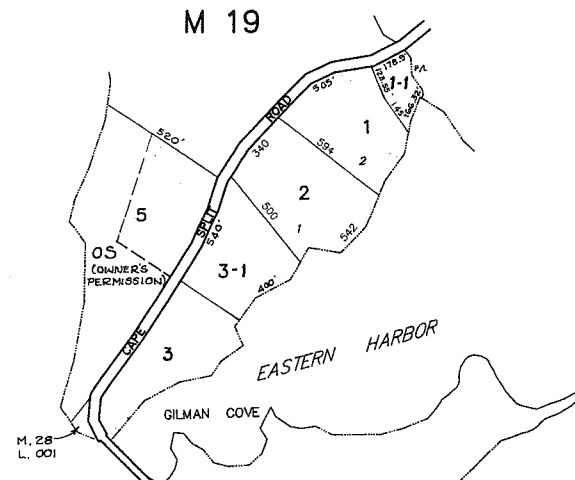

M 28

CAPE SPLIT

WESTERN BAY

EASTERN HARBOR

CAPE SPLIT HARBOR



"SOUTH ADDISON VILLAGE"

M 2

M 23

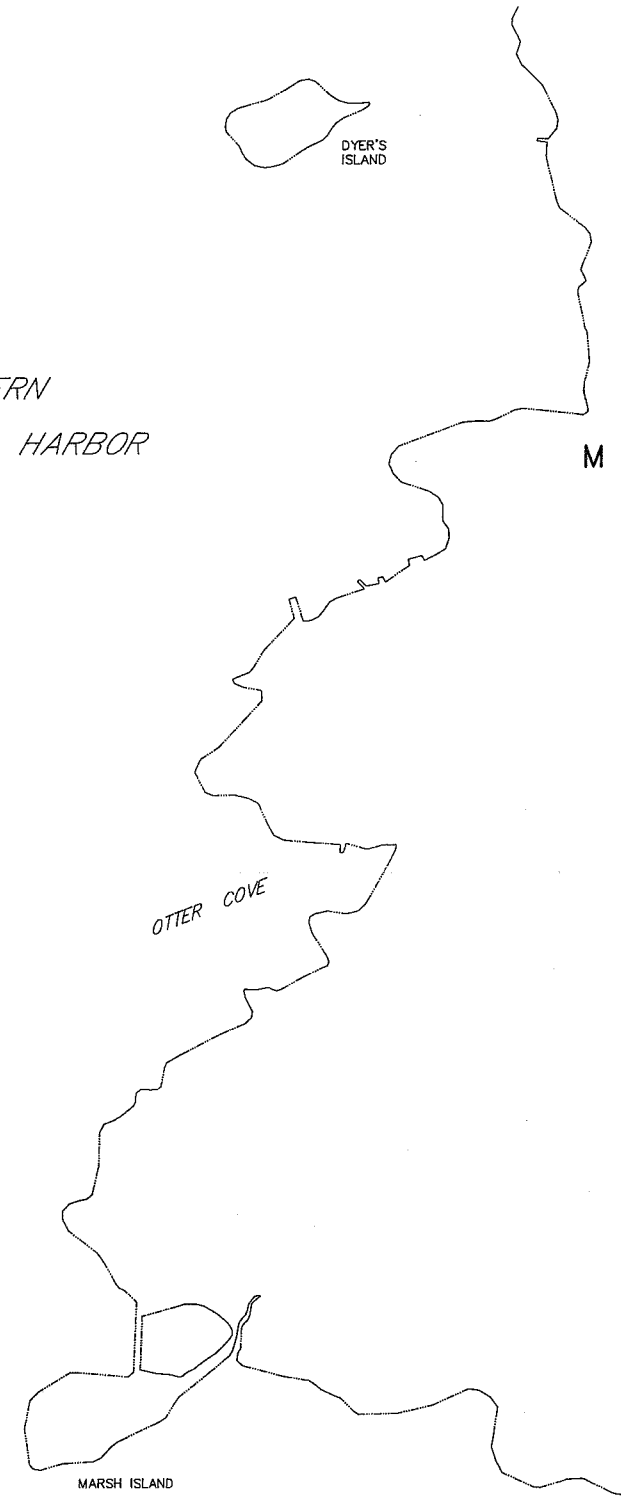

TIBBETT NARROWS

MOOSE NECK

PREPARED BY: AERIAL SURVEY & PHOTO, INC.
NORRIDGEWOCK, MAINE

NOTE: FOR ASSESSMENT PURPOSES ONLY, NOT TO BE USED FOR CONVEYANCES

LEGEND: PARCEL NUMBER.....12
ADJACENT MAP.....M5

Eastern Mapping Services
115 North Road
Newburgh, ME 04444
Tel. (207) 234-2777
Updated April 1, 2011

PROPERTY MAP
TOWN OF ADDISON
WASHINGTON COUNTY, MAINE

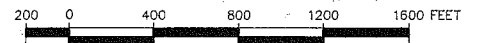

SCALE: 1"=400' APRIL 1, 1992