

PLEASANT BAY

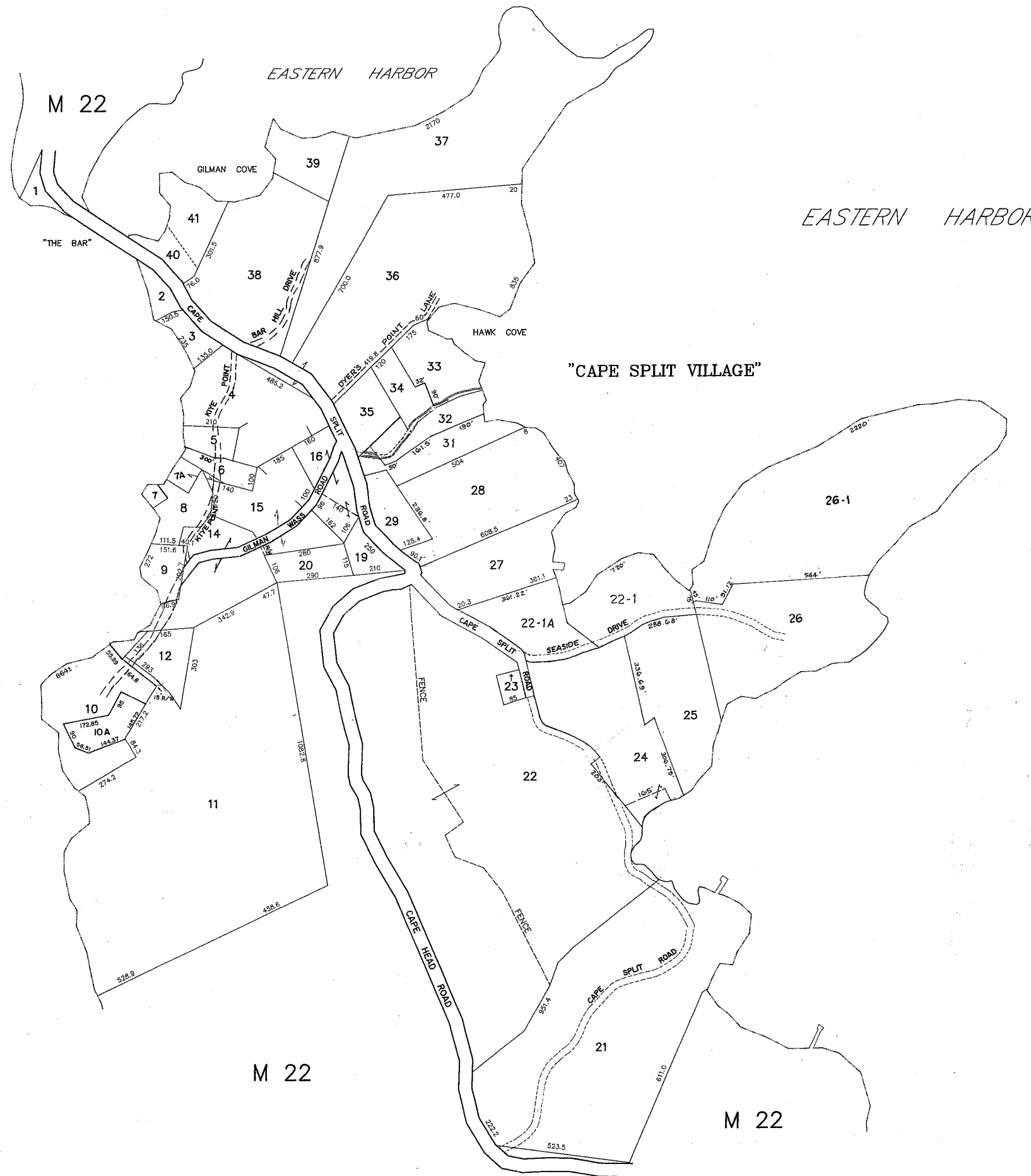

PREPARED BY: AERIAL SURVEY & PHOTO, INC.  
NORRIDGEWOCK, MAINE

NOTE: FOR ASSESSMENT PURPOSES ONLY, NOT TO BE USED FOR CONVEYANCES

LEGEND: PARCEL NUMBER..... 12  
ADJACENT MAP..... M5

Eastern Mapping Services  
115 North Road  
Newburgh, ME 04444  
Tel. (207) 234-2777  
Updated April 1, 2011

PROPERTY MAP  
TOWN OF ADDISON  
WASHINGTON COUNTY, MAINE

100 0 200 400 600 800 FEET

SCALE: 1"=200'

APRIL 1, 1992