

COLUMBIA

COLUMBIA FALLS

HARRINGTON

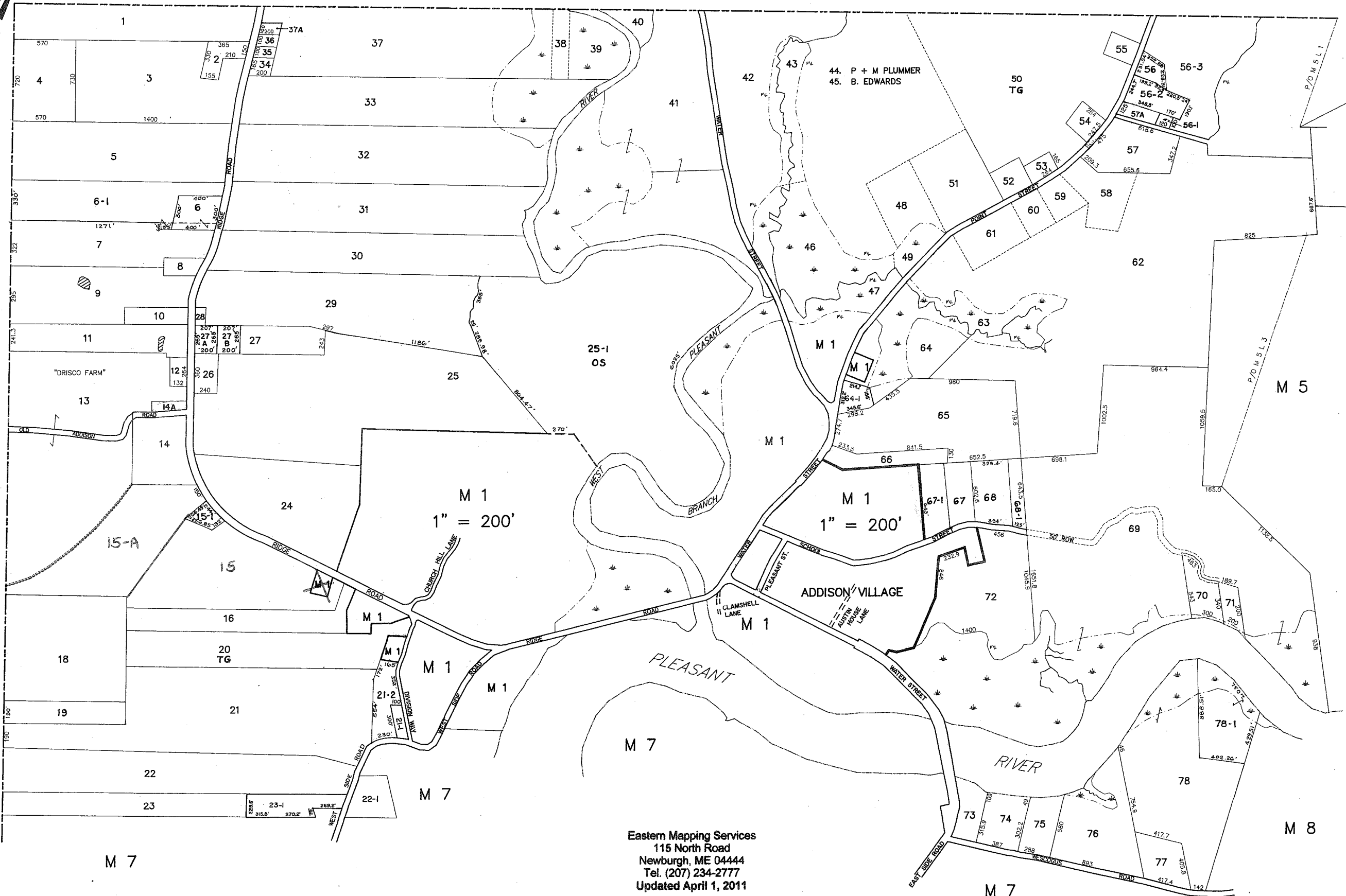

M 1
1" = 200'

M 1
1" = 200'

Eastern Mapping Services
 115 North Road
 Newburgh, ME 04444
 Tel. (207) 234-2777
 Updated April 1, 2011



PROPERTY MAP
TOWN OF ADDISON
 WASHINGTON COUNTY, MAINE

PREPARED BY: AERIAL SURVEY & PHOTO, INC.
 NORRIDGEWOCK, MAINE

NOTE: FOR ASSESSMENT PURPOSES ONLY, NOT TO BE USED FOR CONVEYANCES

LEGEND: PARCEL NUMBER.....12
 ADJACENT MAP.....M5
 MARSH LINE.....